

Received & Inspected
AUG 08 2016
FCC Mail Room

KSUU
Attn: Lance Jackson
Southern Utah University
351 W. University Blvd.
Cedar City , Utah 84720

August 1, 2016

Federal Communications Commission
Attention: Audio Division (Radio)
Washington, D.C. 20554

Dear Sir/Madam:

R.E: Change in location of main studio for KSUU

This letter will notify you of the change in location for the main studio of KSUU - licensed to Southern Utah University.

As you can see from the included map, the studio is being moved from a location in the Centrum Arena (Room 239). To a new location in the Sharwan Smith Student Center (Room 174G). The change is expected to be complete before August 22, 2016.

The mailing address and other contact information will remain the same and the main studio is still within the city of license. Please let me know if you have questions or concerns.

Sincerely,



Lance Jackson
Technology Engineer

CAMPUS BUILDINGS

1. **AL** J. Reuben Clark, Jr. Alumni House
2. **AM** Adam's Memorial Theatre
3. **AU** Auditorium
4. **BB** Bennion Building
5. **BBF** Bud Bowman Building
6. **BC** R.C. Bratton/Liberal Arts Center & Bratton/Liberal Arts Gallery
7. **BSF** Softball/Soccer Fields
8. **BM** Burch Mann House
9. **BU** Dixie Leavitt Business Building
10. **CA** Carter-Carlton
11. **CC** R. Haze Hunter Conference Center
12. **CDL** Shakespeare Child Care Center
13. **CEC** Community Engagement Center
14. **CFA** Beverley Taylor Sorenson Center for the Arts (under construction)
15. **CH** Cedar Hall
16. **CI** Confucius Institute & International Services
17. **CN** Centrum Arena
18. **COC** Community Outreach Center
19. **ED** Emma Eccles Jones Education Building
20. **ELC** Electronic Learning Center
21. **ELL** Eccles Living and Learning Center
22. **FM** Facilities Management Administration
23. **FMS** Facilities Management Shops
24. **GC** General Classroom Building
25. **HC** J.D. & Alice C. Harris Center
26. **HP** Heat Plant
27. **JT** Randall L. Jones Theatre
28. **LEC** Leadership Engagement Center
29. **LIB** Gerald R. Sherratt Library
30. **MC** Multipurpose Center
31. **MT** Motor Pool/Receiving
32. **MU** Music Center
33. **OM** Old Main
34. **PC** Pickleball Courts
35. **PD** SUU Police Department
36. **PEB** J.L. Sorenson Physical Education Building
37. **PF** Practice Fields
38. **PR** President's Residence
39. **PT** Ponderosa Terrace
40. **RCC** Rocky Mountain Power Challenge Course
41. **SC** Science Center
42. **SCA** L.S. & Aline W. Skaggs Center for Health & Molecular Sciences
43. **SH** South Hall
44. **SM** Eccles Coliseum (the stadium)
45. **ST** Sharwan Smith Student Center
46. **TC** Tennis Courts
47. **TH** Engineering & Technology

SU SOUTHERN UTAH UNIVERSITY

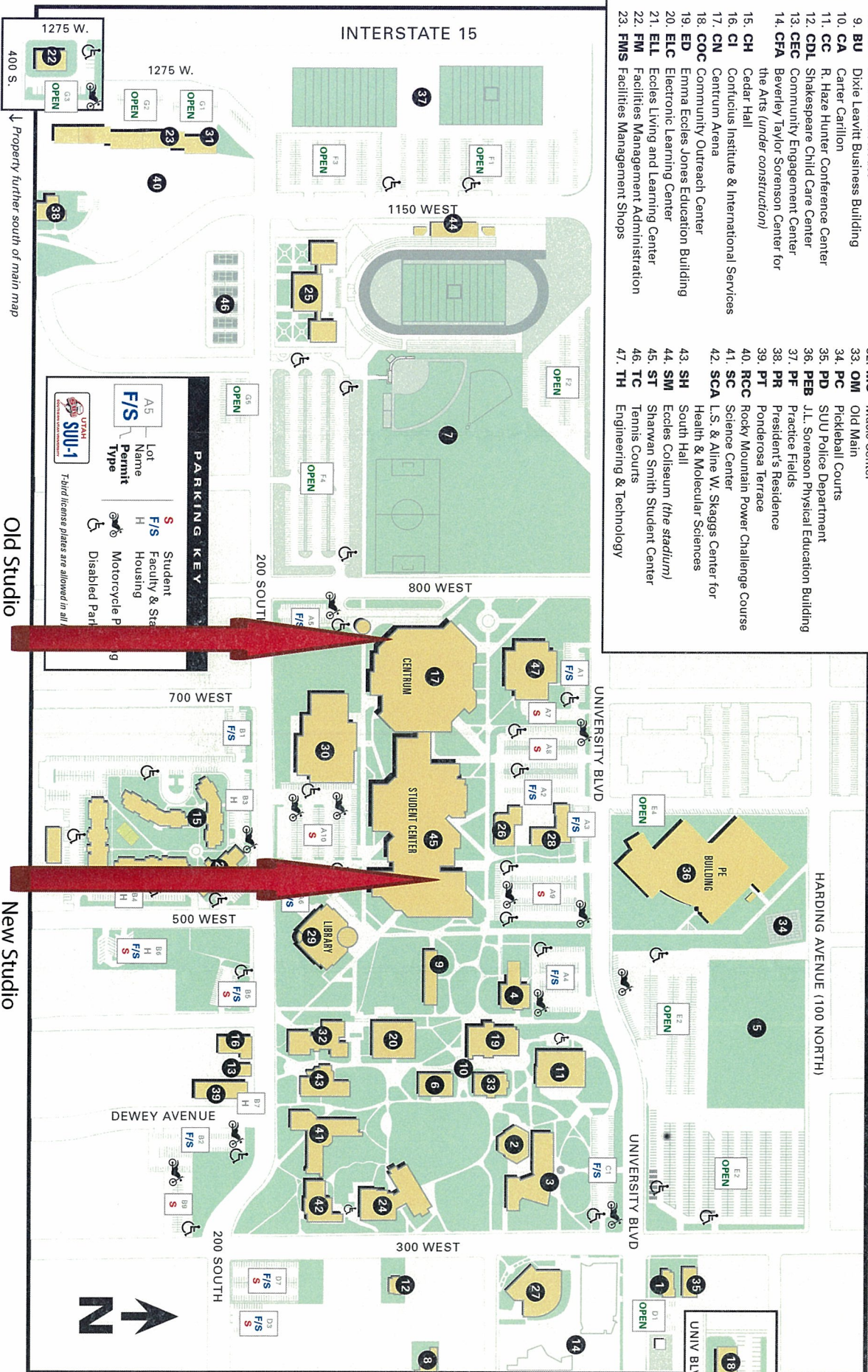
CAMPUS



PARKING KEY

- S** Student
- F/S** Faculty & Staff
- H** Housing
- M** Motorcycle Parking
- D** Disabled Parking

UTAH SUU-1
Third license plates are allowed in all

Old Studio

New Studio

Property further east of main map

Property further south of main map